



Comhairle Chontae Chill Chainnigh

Halla an Chontae Sraid Eoin Cill Chainnigh
R95 A39T

Pobail agus Áiteanna Inbhuanaithe a Chruthú

Kilkenny County Council

County Hall John Street Kilkenny
R95 A39T

Creating Sustainable Communities and Places

Date: 7th December, 2023

Our ref: D28/693/A

**TO: THE CATHAOIRLEACH
AND EACH MEMBER OF KILKENNY COUNTY COUNCIL**

RE: DISPOSAL OF INTEREST IN LAND AT POULGOUR, WETLANDS, KILKENNY

A Chara,

Notice is hereby given, that at a meeting of the Council to be held after the expiration of 10 days from the date of this notice, it is the intention of Kilkenny County Council, in accordance with Section 183 of the Local Government Act, 2001, to dispose of its interest in land at Poulgour, Wetlands, Kilkenny - as identified on the attached map - to Cairn Homes Properties Limited, 7 Grand Canal Street Lower, Dublin 2, for the nominal sum of €10.00 and Kilkenny County Council will be responsible for all legal costs associated with the sale in accordance with standard rates of payments for legal fees under CPO procedures. Combined area measures 0.14 hectare. The Consent of the Minister for Housing, Local Government and Heritage is not required.

BACKGROUND

A previous disposal was approved by the Elected Members at their Meeting held 28th July, 2023. It has now come to attention however that the area to be disposed of stated as 0.24 hectare, is incorrect and should in fact be 0.14 hectare. All other terms and conditions of the Section 183 Notice remain the same and the Notice approved in July will be rescinded.

Mise, le meas,

Martin Prendiville

Martin Prendiville
Head of Finance



654829.585mN
649889.597mE

U.S. Sheet 4766-18

655135.251mN
649939.597mE

U.S. Sheet 4766-C

654829.585mN
649889.597mE

Kilkenny Western Environs Infrastructure Scheme Compulsory Purchase Order No.2 of 2006

AREAS: All shown	Townland: AS Shown	Date: 30/06/23
Scale: 1/2500	D.S. Map Ref: AS Shown	Prepared by: ID
Kilkenny County Council, County Hall, John St., Kilkenny, Tel: 056/7794000 KWE/123/30		
Comhairle Chathair Chillínínigh		

Ref	Owner or Reputed Owner	Area ha	Townland	Description
Plot D	Acquired by CPO by Kilkenny County Council from St. Kierans College	0.0104	Wetland	Road bed
Plot I	Acquired by CPO by Kilkenny County Council from St. Kierans College	0.0072	Wetland	Road space

Lands to be transferred from Kilkenny County Council to Cairn Homes Properties Limited shown outlined in red (Section 183)

Based on Ordnance Survey map of Ireland, Licence No. Kilkenny County Council: 2023/21/CDM.

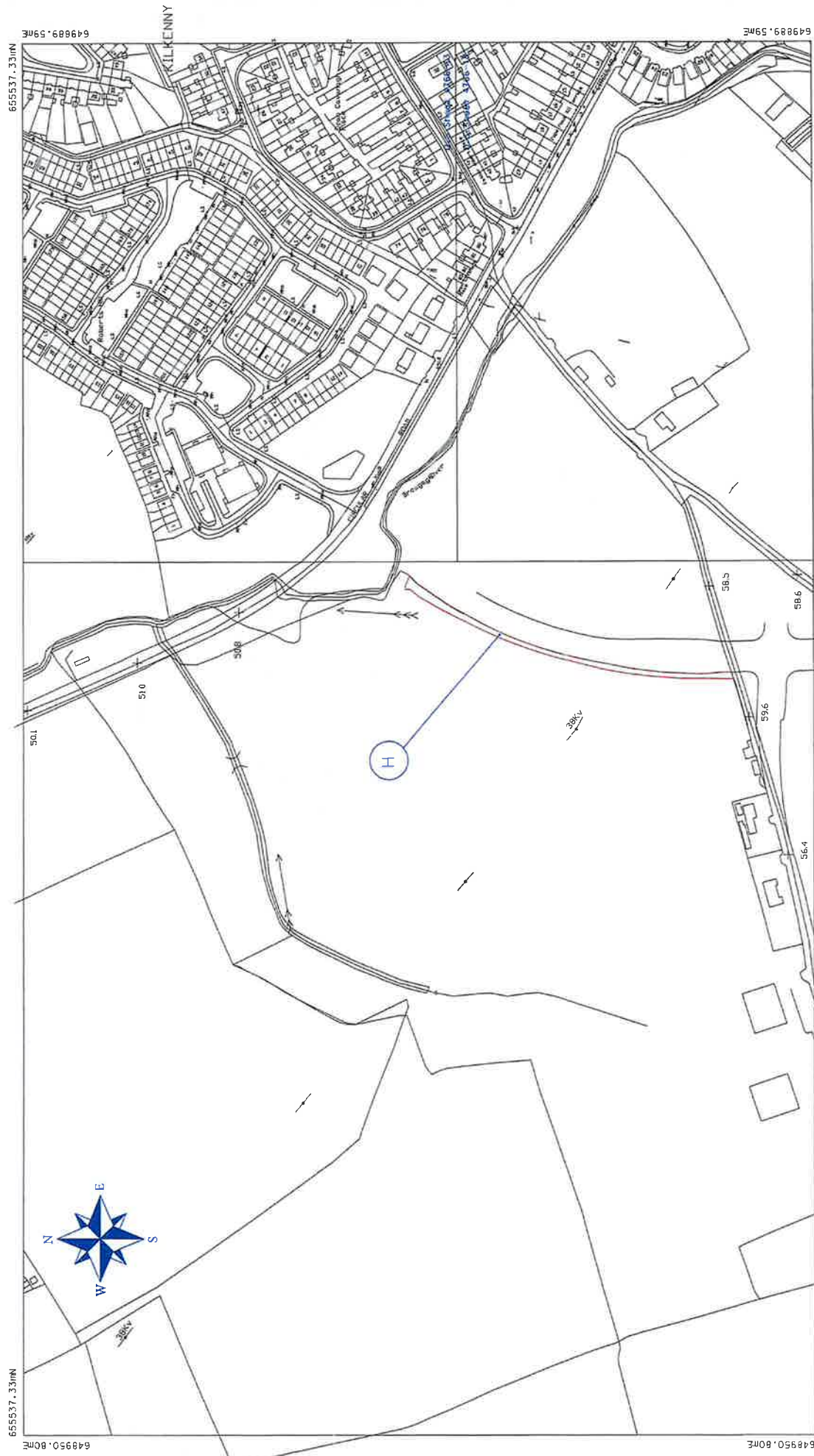

Kilkenny Western Environs Infrastructure Scheme
 Compulsory Purchase Order No.2 of 2006



Areas: As shown	Townland: As Shown	Date: 22/05/23
Scale: 1/2500	O.S. Map Ref: As Shown	Prepared by: pd
Kilkenny County Council, County Hall, John St., Kilkenny. Tel: 056/7794000		Drawing No. KWE/LR/123/35
Chairman: Mairead Chaitie		Scale: 1/2500

Based on Ordnance Survey map of
 Ireland, Licence No. Kilkenny County
 Council 2003/27/ADM.

Lands to be transferred from Kilkenny County Council
 to Cairn Homes Properties Limited shown outlined in red. Section 183.

Ref	Owner or Reputed Owner	Area ha	Townland	Townland
Plot H	Acquired by CPD by Kilkenny County Council from St. Kierans College	0.092	Westland	Land

655537.33mN
 64989.59mE
 64950.80mE
 655003.46mN